

Sealing Elements*

Part Number	Description
150848	7 1/16" 3M/5M NR
150847	7 1/16" 3M/5M NBR
150988	7 1/16" 10M NR
150987	7 1/16" 10M NBR
152272	9" 3M/5M NR
150996	9" 3M/5M NBR
150966	9" 5M NBR
150579	11" 3M NR
150578	11" 3M NBR
150809	11" 5M NR
150810	11" 5M NBR
150577	13 5/8" 3M/5M NR
150576	13 5/8" 3M/5M NBR
150800	21 1/4" 2M NR
150799	21 1/4" 2M NBR

*For Seal & Wear Band Kits See Page J2



Tripple M Oil Tool, Inc.
8317 Andrews Hwy.
Odessa, TX 79765

D9

Spherical BOP Parts - Bolted Cover Models

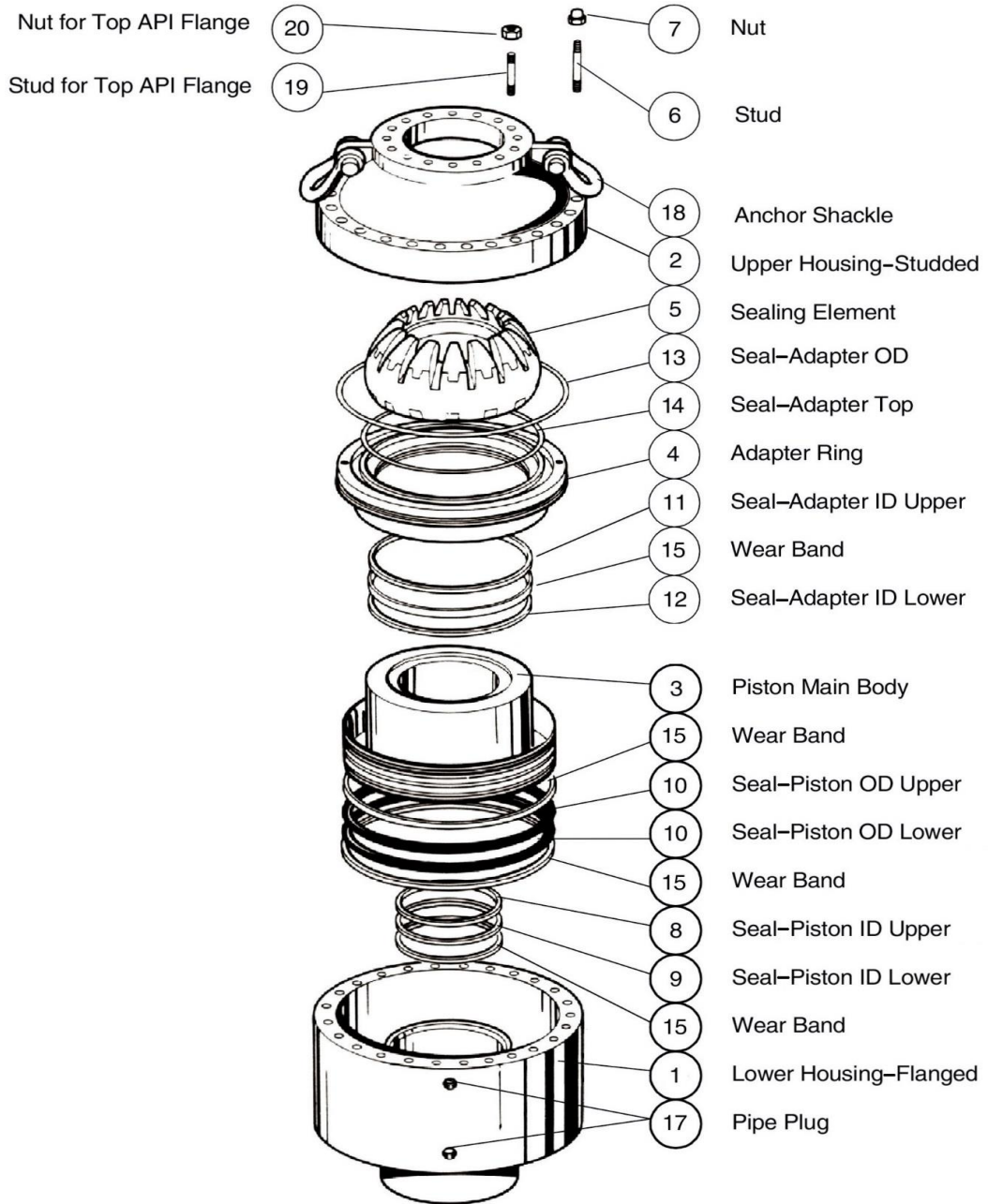

Tripple M Oil Tool, Inc.
 8317 Andrews Hwy.
 Odessa, TX 79765

Phone: 432-337-1452 Fax: 432-367-1115

D10

Spherical BOP Parts - Bolted Cover Models

			10,000		5,000					
Item #	Descr.	Qty. Req.	7 1/16"	4 1/16"	13 5/8"	13 5/8" Lt. Wt.	11"	11" Lt. Wt.	9"	7 1/16"
1	Lower Housing	1	150982	155238	152451	152253	152406	152410	152232	152174
2	Upper Housing	1	150983	152315	152453	151059	152328	152413	151002	150726
3	Piston	1	150984	155241	152148	150736	152326	152326	151003	150718
4	Adapter Ring	1	150985	152313	151933	151964	152323	152323	152236	152163
5	Natural Element		150988	152377	150577	150577	150809	150809	152272	150848
5	Nitrile Element		150987	152376	150576	150576	150810	150810	150996	150847
6	Stud		150989	150730	150659	151060	150648	011033	150999	150730
7	Nut		020111	020106	020111	020110	020110	020109	020108	020106
8	Seal - Piston I.D. Upper	1	031102	031121	031097	031111	031113	031113	031110	031105
9	Seal - Piston I.D. Lower	1	031102	031121	030770	030780	031152	030780	031002	031000
10	Seal - Piston O.D.	2	030765	031123	031029	030782	031018	031018	030765	030780
11	Seal - Adapter I.D. Upper	1	031100	031122	031096	031096	031114	031114	031109	031104
12	Seal - Adapter I.D. Lower	1	031100	031122	030771	030771	030781	030781	031037	031002
13	Seal - Adapter O.D.	1	030773	031124	030772	031011	030783	030783	031126	030408
14	Seal - Adapter Top	1	031035	031125	031094	030773	031115	031115	031036	030405
15	Wear Band		150613	152344	150613	150613	150613	150613	150613	150613
17	Pipe Plug	2	066328	066327	066329	066329	066328	066328	066328	066335
18	Anchor Shackle	2	060498	060500	060498	060498	060497	060497	060494	060496
19	Stud API		011020	011010	011023	011024	011026	011026	011023	012262
20	Nut API		020000	020003	020012	020012	020014	020014	020012	020011
‡	Wear Ring - Adapter Ring	1	152344	152344	152344	-	150613	-	-	152344
‡	Eye Bolts	2	050243	060246	050243	050243	050243	050243	050243	050243
‡	Hammer Wrench	1	050713	050821	050713	050825	050825	050824	050823	050821
‡	Pipe Plug 1/2" NPT	1	066326	066326	066326	066326	066326	066326	066326	066326
‡	Pipe Plug 1/4" NPT	1	065008	065008	065008	065008	065008	065008	065008	065008
‡	Seal Kit	1	155050	155092	155070	155073	155030	155030	155076	155079C

‡Not Shown

Spherical BOP Parts - Bolted Cover Models

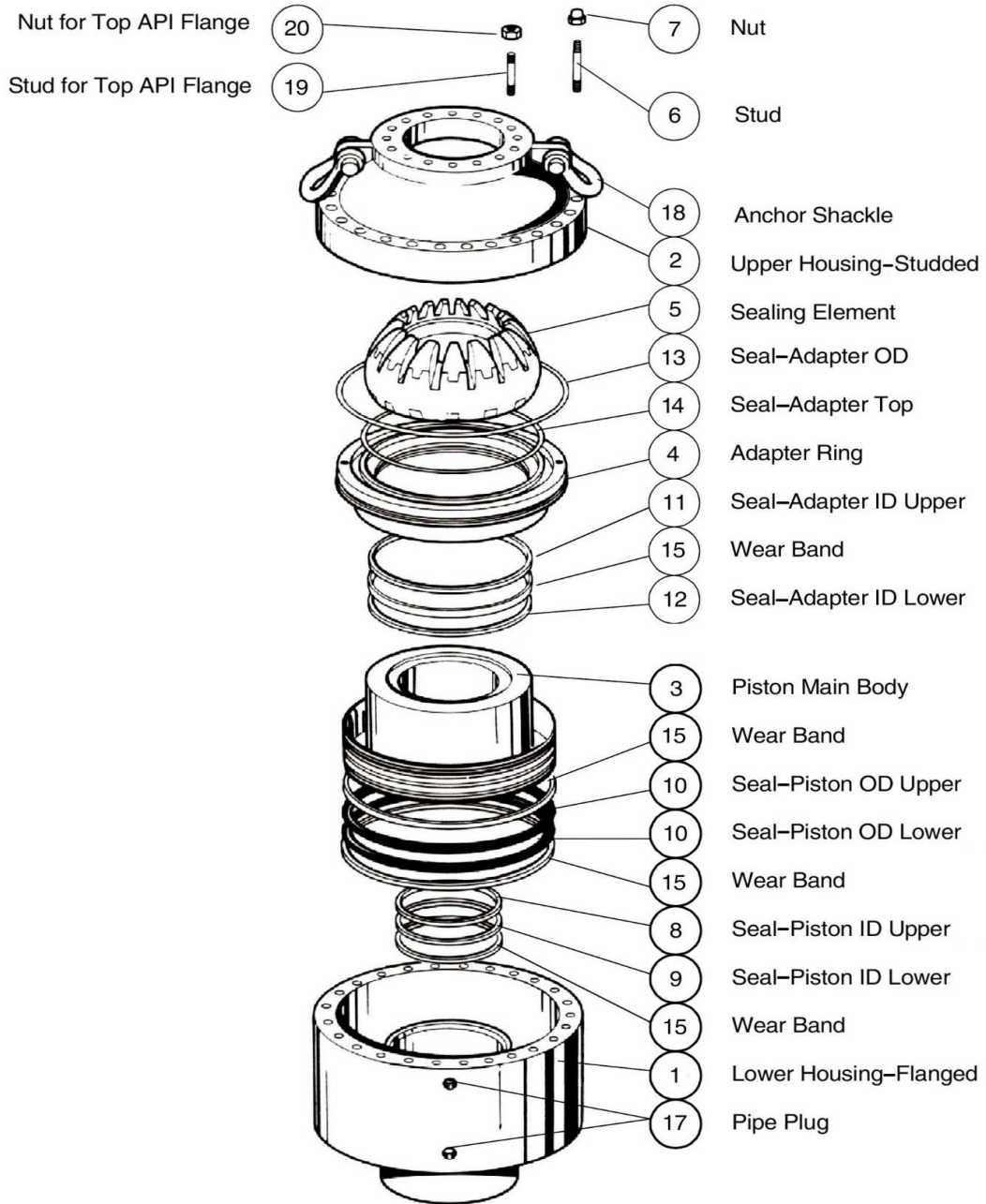

Tripple M Oil Tool, Inc.
 8317 Andrews Hwy.
 Odessa, TX 79765

Phone: 432-337-1452 Fax: 432-367-1115

D12

Spherical BOP Parts - Bolted Cover Models

Item #	Descr.	Qty. Req.	3,000					2,000	
			20 3/4"	13 5/8"	11"	9"	7 1/16"	21 1/4"	21 1/4" Lt. Wt.
1	Lower Housing	1	156512	151974	152019	152178	152420	152204	152195
2	Upper Housing	1	156513	150735	150486	150992	150717	151690	151690
3	Piston	1	156523	150736	150498	152837	150718	155623	150750
4	Adapter Ring	1	156521	151964	152026	152827	151831	152183	152183
5	Natural Element		150800	150577	150579	152272	150848	150800	150800
5	Nitrile Element		150799	150576	150578	150996	150847	150799	150799
6	Stud		156528	155661	150487	155663	150721	150832	150832
7	Nut		020110	020109	020108	020106	020104	020107	020107
8	Seal - Piston I.D. Upper	1	031108	031111	031099	031110	031105	031108	031108
9	Seal - Piston I.D. Lower	1	030761	030780	031101	031002	031000	030761	030761
10	Seal - Piston O.D.	2	031013	030782	030765	031012	030780	030767	030767
11	Seal - Adapter I.D. Upper	1	031107	031096	031098	031109	031104	031107	031107
12	Seal - Adapter I.D. Lower	1	031018	030771	030761	031037	031002	031018	031018
13	Seal - Adapter O.D.	1	031031	031011	030760	030784	030408	031019	031019
14	Seal - Adapter Top	1	031027	030773	031095	031145	030244	031027	031027
15	Wear Band		150613	150613	150613	150613	150613	150613	150613
17	Pipe Plug	2	066329	066329	066335	066335	066335	066329	066329
18	Anchor Shackle	2	060498	060497	060499	060499	060500	060498	060498
19	Stud API		011028	011016	011015	011014	011011	011023	011023
20	Nut API		020015	020011	020011	020011	020003	020012	020012
‡	Wear Ring - Adapter Ring	1	152344	-	-	-	152344	-	-
‡	Eye Bolts	2	050243	050243	050243	050243	050243	050243	050243
‡	Hammer Wrench	1	050825	050824	050823	050821	050819	050822	050822
‡	Pipe Plug 1/2" NPT	1	066326	066326	066326	066326	066326	066326	066326
‡	Pipe Plug 1/4" NPT	1	065008	065008	065008	065008	065008	065008	065008
‡	Seal Kit	1	156527	155073	155075	155077	155079C	155067	155067

‡Not Shown